

**Cleva**

**[cleva-solutions.com](http://cleva-solutions.com)**

# Core Solution for the Life and Non-Life Insurance Market



€50

million  
turnover in  
2024



550+

employees  
in 6 offices  
(Lisbon, Lyon,  
Madrid, Nantes,  
Paris, Porto)



50k +

man-days  
invested  
in R&D  
(2024)



40+

years of  
specialisation  
in the  
insurance  
sector

OUR REFERENCES **60+ CLIENTS IN 8 COUNTRIES**

Portugal France Spain Belgium Luxembourg Angola Mozambique Cape Verde

Isaac da Cunha,  
**Crédit Agricole Assurances**

*Cleva is very important to our organisation as it is the heart of our business for our activities both in Spain and Portugal. It is a strategic partner for us.*

Stéphan Reuge,  
**PRO BTP**

*Thanks to Cleva, we will be able to manage all our group and individual activities in a single, modular tool, with accelerated go-to-market capabilities.*

## MODERN USER INTERFACE

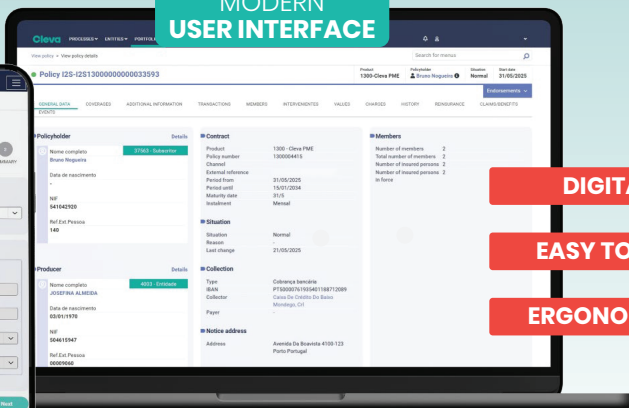
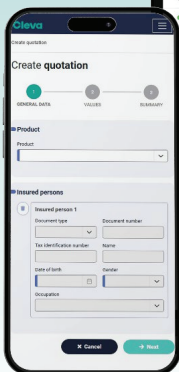

DIGITAL

EASY TO USE

ERGONOMICS

# The Core Solution for Life and Non-Life Insurance

## Cleva Life



Risk



Savings

## Cleva Non-life



P&C



Health

## Adaptable, connected, and built for today's market challenges

### INTEGRATION

- Comprehensive API ecosystem ensuring security and performance
- Full autonomy for clients and partners to connect seamlessly

### PROCESSES

- End-to-end workflows for underwriting and claims management
- Configurable business rules and accelerators to drive agility and speed

### CONFIGURATION

- Independence to design, adapt, and launch products quickly
- Business rules configurator built for business users, not just IT

## A modular and integrated system

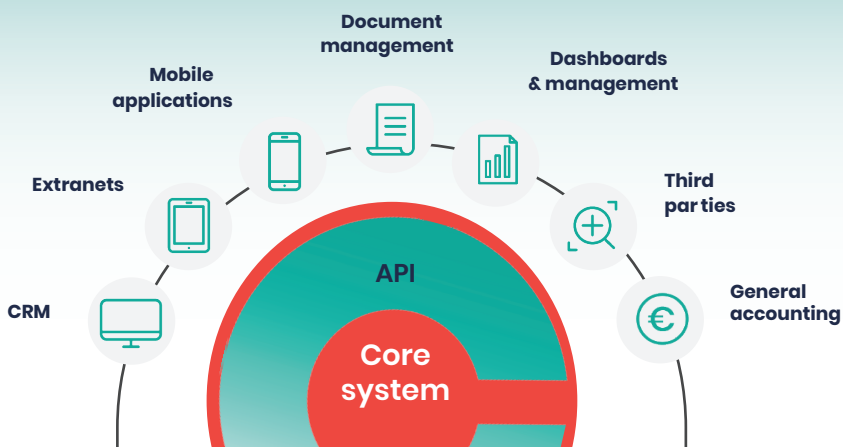

# WE ARE **CLEVA**

**Lisbon**

**Lyon**

**Madrid**

**Nantes**

**Paris**

**Porto**

**cleva-solutions.com**

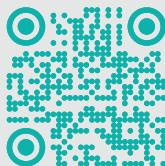

**cleva\_solutions**



**Cleva**



**Cleva Solutions**